

Limit 380

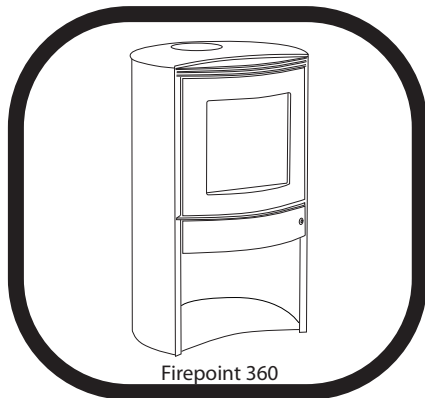

Firepoint 360

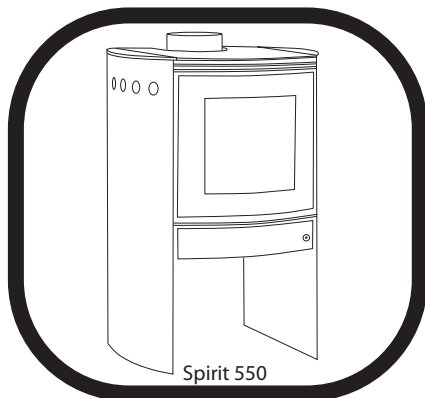

Spirit 550

# BOSCA<sup>®</sup>

## FREESTANDING WOOD STOVES

### INSTALLATION MANUAL

This manual includes instructions for the Installation,  
Operation and Maintenance of your stove.

Models  
Limit 380  
Firepoint 360  
Spirit 550

Please read this entire manual carefully  
before installing and lighting your stove.  
Save these instructions for future use.

Always follow the instructions contained in the manual.

## TABLE OF CONTENTS

PRINCIPAL COMPONENTS	1
INTRODUCTION	2
INSTALLATION	2
What is the most adequate location to install my Bosca stove?	2
What is the correct way to install my Bosca stove?	4
Floor protectors	4
Seismic restraints (New Zealand installations only)	4
REMOVING THE FIREBOX BAFFLE	6
How can I verify that the installation has been correctly executed?	6
OPERATING INSTRUCTIONS	6
How does the double combustion system work?	6
How do I choose appropriate firewood?	6
How can I recognize dry firewood before buying it?	7
How do I check that the firewood is dry before using it?	7
How do I light the stove?	7
How do I reload firewood in the stove?	8
How do I turn off the stove?	8

MANTENANCE AND CLEANING	8
What maintenance does my Bosca stove require?	8
How do I clean the flues on my stove?	9
How do I remove the ash from my stove?	10
How do I clean the glass panel on my stove?	10
CHIMNEY FIRE	10
What is a chimney fire?	10
What should I do in case of a chimney fire?	10
How can I avoid a chimney fire?	10
TROUBLESHOOTING	11
IMPORTANT INFORMATION	11
SAFETY PRECAUTIONS	11
WARRANTY	12

### DISTRIBUTED IN NEW ZEALAND BY:

ESCEA LTD

PH: 03 478 8220

FAX: 03 478 8221

EMAIL: [info@escea.co.nz](mailto:info@escea.co.nz)

17 CARNFORTH ST  
GREEN ISLAND  
DUNEDIN  
NEW ZEALAND

## MAIN COMPONENTS

- ① Flue Spigot
- ② Ceramic Glass (Resists temperatures up to 800°C)
- ③ Ashtray Door
- ④ Locking System
- ⑤ Ashpan
- ⑥ Refractive Bricks
- ⑦ Removable Baffle
- ⑧ Combustion Control (Primary Air Control)

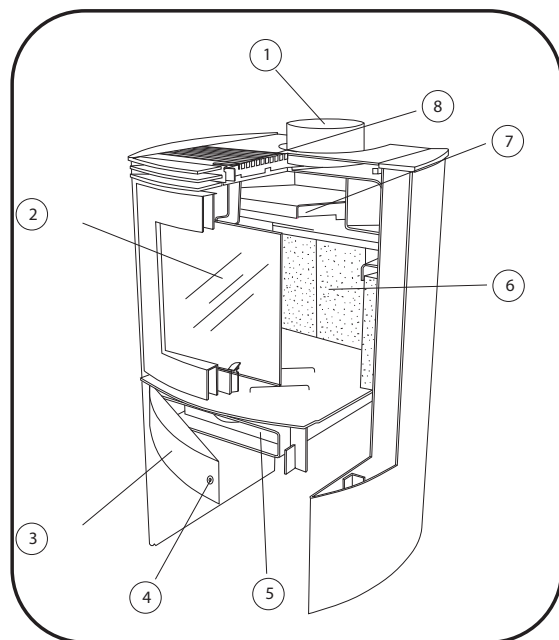

WARNING: THIS APPLIANCE AND FLUE SYSTEM SHALL BE INSTALLED IN ACCORDANCE WITH AS/NZS 2918 AND THE APPROPRIATE REQUIREMENTS OF THE RELEVANT BUILDING CODE OR CODES.

WARNING: APPLIANCES INSTALLED IN ACCORDANCE WITH THIS STANDARD SHALL COMPLY WITH THE REQUIREMENTS OF AS/NZS 4013 WHERE REQUIRED BY THE REGULATORY AUTHORITY, I.E. THE APPLIANCE SHALL BE IDENTIFIABLE BY A COMPLIANCE PLATE WITH THE MARKING 'TESTED TO AS/NZS 4013'.

ANY MODIFICATION OF THE APPLIANCE THAT HAS NOT BEEN APPROVED IN WRITING BY THE TESTING AUTHORITY IS CONSIDERED TO BE IN BREACH OF THE APPROVAL GRANTED FOR COMPLIANCE WITH AS/NZS 4013

CAUTION: MIXING OF APPLIANCE OR FLUE SYSTEM COMPONENTS FROM DIFFERENT SOURCES OR MODIFYING THE DIMENSIONAL SPECIFICATION OF COMPONENTS MAY RESULT IN HAZARDOUS CONDITIONS. WHERE SUCH ACTION IS CONSIDERED, THE MANUFACTURER SHOULD BE CONSULTED IN THE FIRST INSTANCE.

CAUTION: CRACKED AND BROKEN COMPONENTS, e.g. GLASS PANELS OR CERAMIC TILES, MAY RENDER THE INSTALLATION UNSAFE

WARNING: ANY MODIFICATION OF THE APPLIANCE THAT HAS NOT BEEN APPROVED IN WRITING BY THE TESTING AUTHORITY IS CONSIDERED AS BREACHING AS/NZS 4013

WARNING: DO NOT USE FLAMMABLE LIQUIDS OR AEROSOLS TO START OR REKINDLE THE FIRE.

WARNING: DO NOT USE FLAMMABLE LIQUIDS OR AEROSOLS IN THE VICINITY OF THIS APPLIANCE WHEN IT IS OPERATING.

WARNING: DO NOT STORE FUEL WITHIN HEATER INSTALLATION CLEARANCES.

WARNING: WHEN OPERATING THIS APPLIANCE AS AN OPEN FIRE USE A FIRE SCREEN.

WARNING: OPEN AIR CONTROL (AND DAMPER WHEN FITTED) BEFORE OPENING FIRE DOOR

CAUTION: THIS APPLIANCE SHOULD NOT BE OPERATED WITH A CRACKED GLASS

CAUTION: THIS APPLIANCE SHOULD BE MAINTAINED AND OPERATED AT ALL TIMES IN ACCORDANCE WITH THESE INSTRUCTIONS

CAUTION: THE USE OF SOME TYPES OF PRESERVATIVE-TREATED WOOD AS A FUEL CAN BE HAZARDOUS

KEEP THESE INSTRUCTIONS FOR FUTURE REFERENCE

## INTRODUCTION

Congratulations on purchasing a Bosca stove. By choosing one of our products you automatically receive the support, guarantee and experience of our more than 20 years manufacturing stoves equipped with double ombustion systems that allow for an efficient use of firewood with a minimum impact on the environment.

Bosca products are manufactured using only high quality materials and the latest in design and technology that, in the hands of our experienced workers, ensures our products meet the highest international standards.

Not suitable for wetback or water booster application.

## INSTALLATION

To ensure the safe and proper functioning of your stove, it must be installed according to the instructions included in this manual.

In terms of safety, the flue is the most important component of your stove as it is the exhaust for the gases produced by the combustion of firewood. These gases are extremely corrosive, reach high temperatures and often contain fuel components. Studies have demonstrated that fires related to stove or wood cookstoves usually originate near the flue.

What is the most suitable location to install my Bosca stove?

In the case of a freestanding stove, it is essential to choose a suitable location for its installation. The following are the main considerations you should take into account:

1. It is important that the stove be located in an area that allows for an adequate circulation of air currents. This will enable the hot air to reach the different rooms of the house more easily. Additionally, the stove must be located so that it is not an obstacle to the free circulation of people, especially children.
2. Be especially careful to maintain clearances to flammable material such as curtains and carpets. The minimum installation distances are detailed to the right:

## MINIMUM CLEARANCES FROM COMBUSTIBLE WALLS (mm)

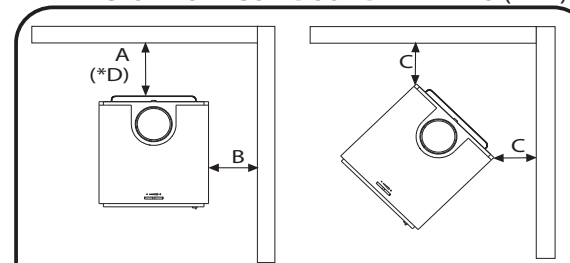

	A	B	C	*D see note below
FIREPOINT 360	315	340	320	195
LIMIT 380	345	325	250	240
SPIRIT 550	230	245	140	N/A

For clearances to non-combustible or insulated walls refer to AS/NZS 2918

Note: For Spirit 550 & Limit 380, side clearance (B) to be no less than 200mm and rear clearance (A) no less than 100mm irrespective of wall material, to ensure access to rear of stove for baffle replacement.

## BOSCA REAR HEAT SHIELD

A Bosca Rear Heat Shield (shown right) is supplied in all Bosca Flue Shield Kits and can be used in conjunction with the flue shield to reduce the rear clearance to the minimum allowable distance.

\*D In the above table denotes the minimum allowable clearances for each model if the Rear Heat Shield is fitted. If the Rear Heat Shield is not fitted then the rear clearance should be no less than that stated in column A.

Note: The Rear Heat Shield cannot be used with the Spirit 550 at any time. The fitting instructions for the Rear Heat Shield can be found with the instructions for the Bosca Flue Shield Kit. The Rear Heat Shield does not replace the Bosca Flue Shield.

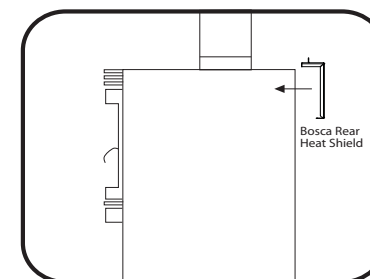

## FLUE SHIELD

The Bosca flue shield (P/N110017) must be used in all installations where the fire is installed against a combustible wall to the clearances listed in the chart on page 2 of this manual.

If the wall behind the fire is a non-combustible ventilated surface as per AS/NZS2918 then clearances can be reduced and the flue shield is not required.

## FLOOR PROTECTOR

Bosca freestanding wood fires DO NOT require an insulating floor protector as they comply with the minimum floor protector requirements of AS/NZS 2918. These minimum floor protector requirements are;

- They must be of adequate size to give appropriate wall, rear and front clearances/projections as detailed below and in the chart illustrated on page "2"

NOTE;

- The floor protector must extend 200mm horizontally to the rear and each side directly below the door opening, and 300mm forward of the door opening.

- The upper surface of the floor protector must be made of non-combustible material.

- A suitable floor protector for a Bosca freestanding wood fire is therefore any non-combustible material which could include;

- Ceramic tiles with grouted joints fixed directly to timber flooring.

- A sheet of toughened glass, panel steel etc laid directly onto a wooden or other combustible floor.

Note; If being installed directly onto concrete or non-combustible floor a floor protector is not necessary.

## FLUE INSTALLATION

Any flue system used on this fire must comply with and be installed as detailed in AS/NZS 2918:2001. We recommend the following kits which are compliant and come complete with instructions.

"Bosca Flue Kit" (available through your Bosca dealer)

"Sheetmetal Fabricated Products Limited 4 metre Freestanding 2400 Flue Kit"

## SEISMIC RESTRAINT

*For New Zealand installations only*

As per NZS 2918, Bosca fires installed in New Zealand are required to have seismic restraint.

This can be achieved in the Limit 380 and Firepoint 360 by using the two holes provided in the baseplate of the fireplace and using masonry anchors if installing onto a concrete floor, or any suitable fastener for wooden floors.

The Spirit 550 is supplied with two Seismic Restraint Brackets welded on each side as it does not have a base plate. By using the two holes in these brackets and using masonry anchors if installing onto a concrete floor, or any suitable fastener for wooden floors.

Must comply with all local council specifications.

Note: the fastener must pass through the Floor Protector if fitted and into the floor.

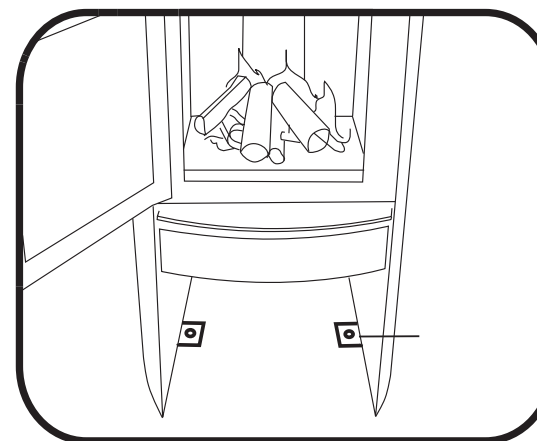

## INSTRUCTIONS FOR REPLACING THE BAFFLE

**BOSCA**® FREESTANDING  
WOOD STOVES

### LIMIT 380

1. The first stage consists of removing the anchoring bolts of the baffle. This will require an 11mm spanner.

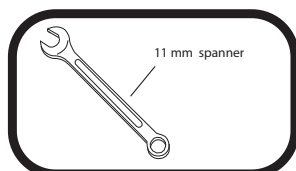

2. Undo the 1/4" (stainless steel) nuts on the back of your stove counter-clockwise with the spanner.

To ease the process, we recommend you first lubricate the nuts with WD40 or a similar product.

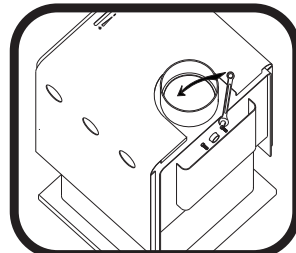

3. Once the nuts are loose, undo them until you have completely removed them from the bolts. Set them aside so as to avoid losing them.

You can now dismount the baffle from inside the stove. Do so from the front of the unit. Place the screws and tighten them.

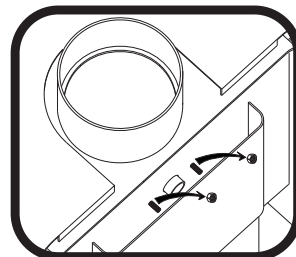

4. To remove the baffle, hold it with both hands and slide it forward so that the bolts separate from the back of the stove.

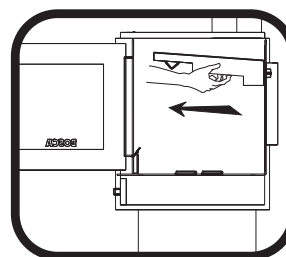

5. To stop the baffle from falling, tilt it slightly from the back so that you can hold it firmly with your hands. Straighten it and remove from the stove.

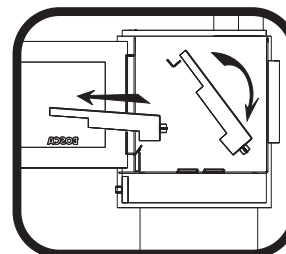

6. To mount the baffle back in its original position, insert it into the firebox as indicated by the arrows and rest it on the supports designed for it.

Ensure the oxygenating tube and the bolts are fully inserted in the perforations located in the back of the stove. Place the nuts and tighten them.

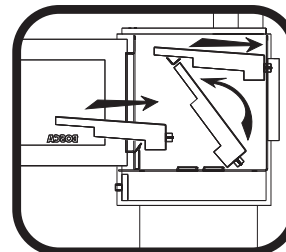

### SPIRIT 500 / 550

1. The Spirit model stove has a dismantable back panel that must be removed. You will need an 11mm spanner to do this.

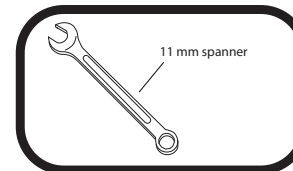

2. Loosen the bolts located on both sides of the panel.

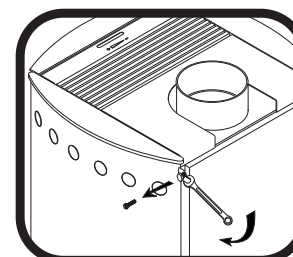

3. Undo the 1/4" (stainless steel) nuts on the back of your stove counter-clockwise with the spanner.

To ease the process, we recommend you first lubricate the nuts with WD40 or a similar product. Once the nuts are loose, undo them until you have completely removed them from the bolts. Set them aside so as to avoid losing them.

You can now remove the baffle from inside the stove. Do so from the front of the stove.

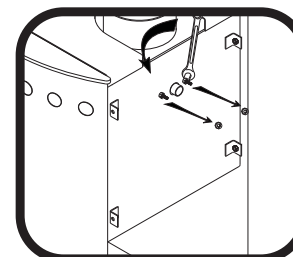

## INSTRUCTIONS FOR REPLACING THE BAFFLE

**BOSCA®** FREESTANDING  
WOOD STOVES

### SPIRIT 500 / 550 (continued)

4. To remove the baffle, hold it with both hands and slide it forward so that the bolts separate from the back of the stove.

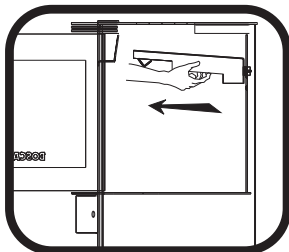

5. To stop the baffle from falling, tilt it slightly from the back so that you can hold it firmly with your hands. Straighten it and remove it from the stove.

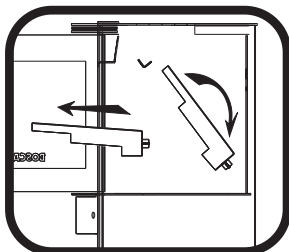

6. To mount the baffle back in its original position, insert it into the firebox as indicated by the arrows and rest it on the supports designed for it. Ensure the oxygenating tube and the bolts are fully inserted in the perforations located in the back of the stove. Place the nuts and tighten them.

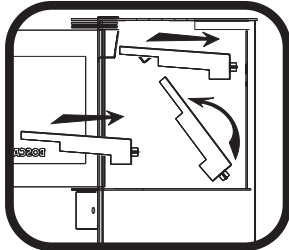

### FIREPOINT 360 / 400

1. The first stage consists of removing the anchoring bolts of the baffle. This will require an 11 mm spanner.

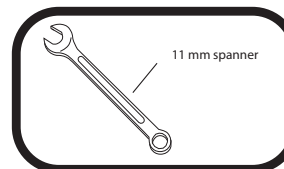

2. Undo the 1/4" (stainless steel) bolts from the inside of your stove counterclockwise with the spanner. To facilitate the process, we recommend you first lubricate the bolts with WD40 or a similar product.

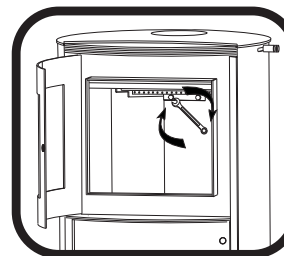

3. Once the bolts are loose, undo them until you have completely removed them from the bolts. Set them aside so as to avoid losing them. You can now remove the baffle from inside the stove. Do so from the front of the unit.

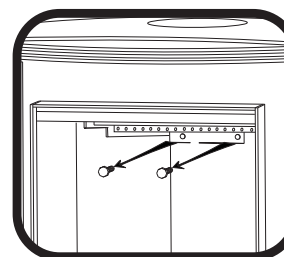

4. To remove the baffle, hold it with both hands and slide it forward so that the bolts separate from the back of the stove.

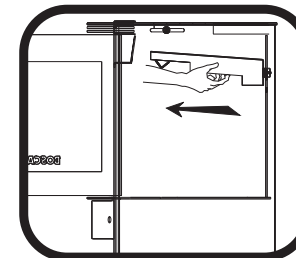

5. To stop the baffle from falling, tilt it slightly from the back so that you can hold it firmly with your hands. Straighten it and remove it from the stove.

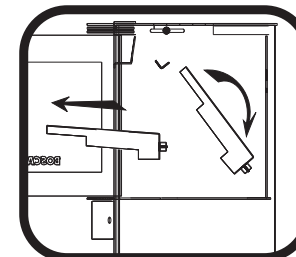

6. To mount the baffle back in its original position, insert it into the firebox as indicated by the arrows and rest it on the supports designed for it. Ensure the oxygenating tube and the bolts are fully inserted in the perforations located in the back of the stove. Place the screws and tighten them.

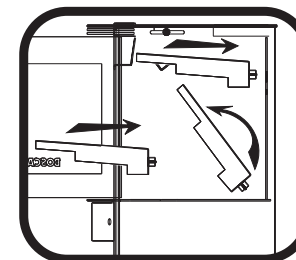

## OPERATING INSTRUCTIONS

**BOSCA®** FREESTANDING  
WOOD STOVES

How can I verify that the installation has been correctly executed?

We are aware of how important it is to you to feel confident that your stove has been properly installed. Therefore, if you wish to verify the installation, we recommend you use the following diagram to guide your inspection:

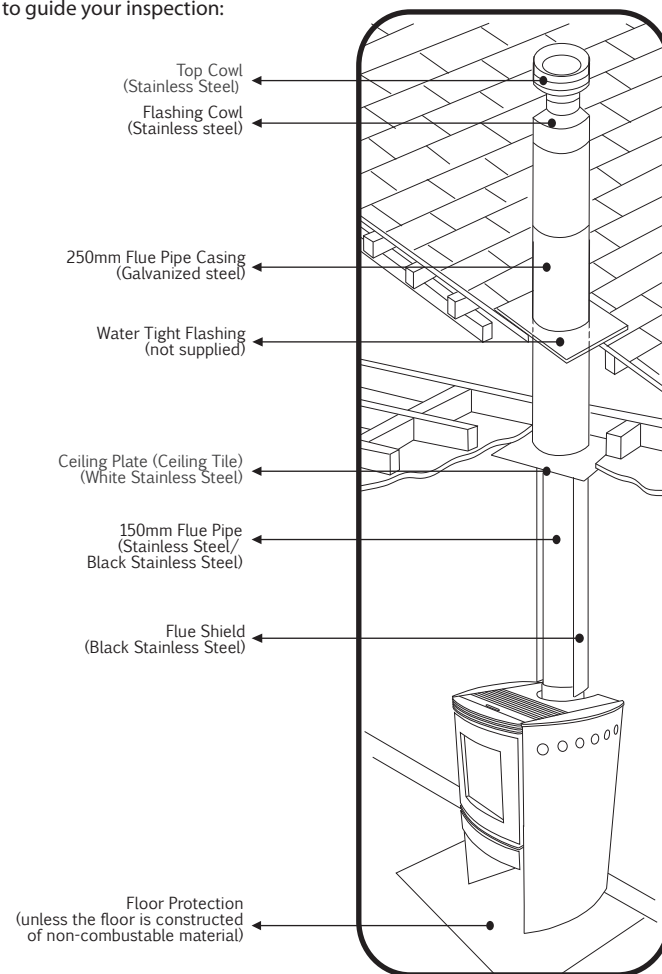

## OPERATING INSTRUCTIONS

How does the double combustion system work?

Double combustion stoves have a secondary air inlet that preheats the air at a high temperature. This hot air mixes with the combustion gases burning the volatile material and reducing particulate material. This process is known as post combustion.

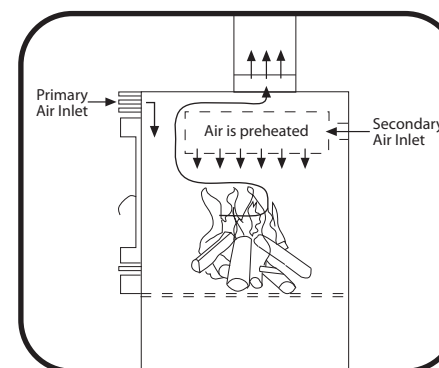

How do I choose appropriate firewood?

It is important that you understand that one of the elements that will allow you to obtain the maximum performance from your stove is the purchase of good quality fuel. To maximize the effectiveness of your stove follow the instructions detailed below on how to buy, store and manipulate firewood:

**BURN ONLY UNTREATED SOFTWOOD DO NOT BURN COAL**

- A highly relevant variable that determines the quality of the firewood is its humidity content. This must be between 18 and 25%, to ensure an adequate duration and avoid energy loss as a result of water evaporation as this reduces the power of the stove. Additionally, by using firewood with low humidity content, you will avoid the production of creosote (a residue of combustion that is deposited on the flues of your stove), resulting in lower maintenance costs.

- Remember to buy firewood that is no longer than 30 cm and approximately 15 cm in diameter. This size firewood fits easily in your stove and the larger logs will not have to be cut to fit.

- Having good quality firewood of appropriate humidity content does not only depend on buying it correctly. This is only the starting point. If the manipulation of the wood is not adequate,



## OPERATING INSTRUCTIONS

## BOSCA® FREESTANDING WOOD STOVES

your efforts will have been wasted. This is why it is important that you safeguard the storage conditions. The wood must be stored in an isolated location so that it is not exposed to rain and receives adequate air circulation. Under no circumstance must it be in contact with the ground unless it is paved.

How can I recognize dry firewood before buying it?

- The logs are lighter.
- The bark must be partially detached and have cracks on the ends.
- It must not have white or grey spots.
- When you bend a small splinter with your fingers, it breaks.

How do I check that the firewood is dry before using it?

Place a log in your stove over a large quantity of cinders and check for the following:

Dry Firewood: ignites on more than one side in minutes.

Humid Firewood: turns grayish-black and takes time to ignite.

Wet Firewood: emits a whistle sound, blackens, does not produce a flame and emits a large quantity of smoke.

**IMPORTANT**  
Wet firewood is NOT apt for use.

How do I light the stove? (Easy Lighting System)

**IMPORTANT**  
The first time the stove is lit the high temperature paint on it will smoke and emit a resin smell for some hours. Open the windows to ventilate.

1. Check that the temperer is in its place, if this is not so locate it in the correct position as indicated on page 8.

2. Place crumpled paper in the middle of the firebox.

3. Place various split logs over the paper and some splinters on top of this, preferably in a vertical position. Set the Primary Air Control on "maximum".

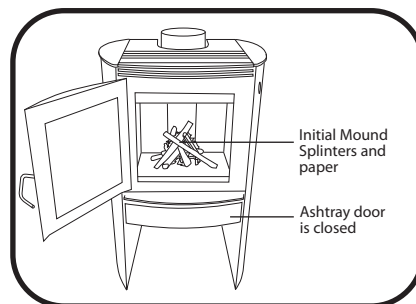

4. Light the fire and close the upper door of the stove.

5. Open the door of the ashtray and keep it this way for approximately 3 minutes or until the splinters are lit.

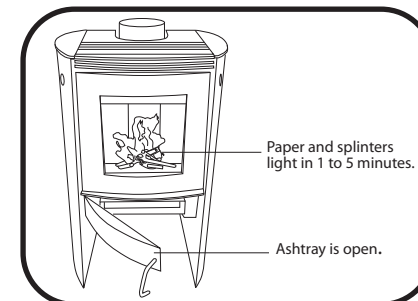

6. Open the upper door and add the load of firewood, placing the lightest logs over the lit splinters. It is very important that spaces are left between the logs as these allow for air circulation and consequently a faster and more vigorous ignition.

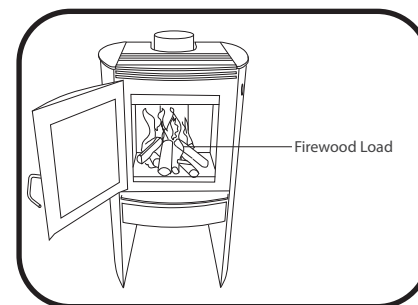

7. Finally, close the door and adjust the Primary Air Control to "maximum" for 5 minutes or until the flames burn vigorously, and then adjust the control to "intermediate".

8. Learning to manage the stove to your liking requires some practice, as you must first become familiar with its functioning. Do not expect an immediate reaction of the fire when you slide the Primary Air Control. The flame will not intensify nor extinguish quickly as is the case with liquid or gas fuels. Solid fuels like firewood react slowly.

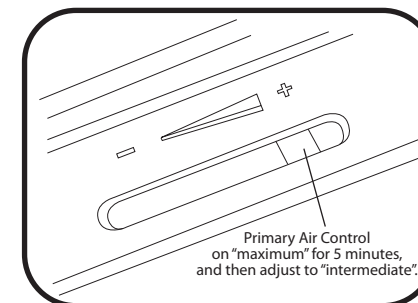

## IMPORTANT

If you follow these instructions you will generate an effective combustion that does not produce smoke nor contamination when you start a fire in your stove, while ensuring its optimum functioning.

## IMPORTANT

The best moment to reload the stove is when a good layer of cinders has set itself. If this layer is too thin, the way to reload it is repeating the initial lighting procedure (page 6).

## How do I turn off the stove?

1. As your stove is a safe unit it is not necessary to turn it off. However, if you wish to do so, all you have to do is adjust the Primary Air Control to "minimum". Remember that solid fuels react slowly, so that this process will take several minutes.

## IMPORTANT

The "minimum" position on the Primary Air Control must only be used to turn off the stove. It must never be used as a way to save firewood, as the effect will be to make the functioning of the stove deficient.

## How do I reload firewood in the stove?

1. Adjust the Primary Air Control to "maximum" and open the door of the firebox (upper door).

2. Place the dry firewood logs on the cinders inside the stove. Logs must be loaded front to back as shown in the figure at right. As is the case when lighting the fire, remember that it is better if the logs are arranged with spaces between them to allow air flow. Finally, close the upper door.

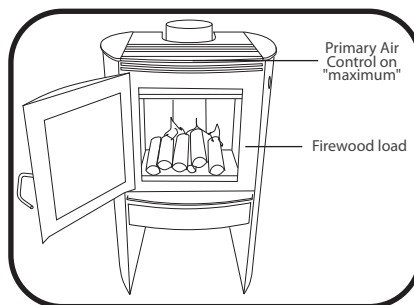

## MAINTENANCE AND CLEANING

### What maintenance does my Bosca stove require?

Cleaning the flues is essential to ensure the proper functioning of your stove. This consists of removing the creosote (a flammable substance that results from the combustion of firewood with a high percentage of humidity and/or when there is insufficient air entering) from the interior of the flue. This accumulation obstructs the flue and affects the proper functioning of your stove, making the lighting process slow and tedious and impeding appropriate combustion. Moreover, the combustion will not be vigorous and there will be insufficient draft and abundant smoke emerging from the door.

## IMPORTANT

Under certain conditions creosote can ignite, resulting in extremely high and dangerous temperatures.

The frequency with which the flues must be cleaned varies according to the percentage of humidity in the firewood you use. The flues must be cleaned at least once a year if the firewood you use is dry. However, if it is green or contains over 25% humidity it must be done every 15 or 20 days.

## OPERATING INSTRUCTIONS

**BOSCA**® FREESTANDING  
WOOD STOVES

We recommend the flues of your stove be cleaned by an Authorized Technical Service. If this is not possible for any reason, you can clean the flues yourself by following the instructions indicated below. The tools you will need are a ladder, a screwdriver and a steel brush. After cleaning the flue, check the state of the seal between the flues and the sheet. If necessary, we recommend you reseal with a suitable high temp sealant.

### How do I clean the flues of my stove?

Your stove is installed in such a way that the flues can be cleaned without uninstalling the unit.

1. Make sure the stove and the flues are both cold before touching them. We recommend you always protect your hands by using safety gloves.



2. Unscrew the cap and remove it.

#### IMPORTANT

Bosca stoves contain a baffle that must be dismantled in order to clean the unit.

3. Remove the anchoring screws to dismount the baffle of your stove. We recommend you carefully read the instructions on removing the firebox baffle.

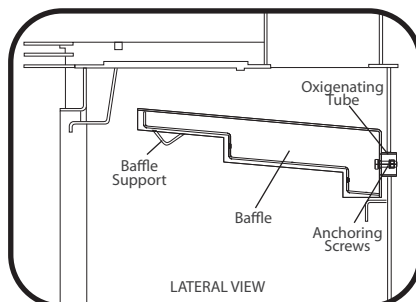

4. It is not necessary to totally remove the baffle from the stove once it is dismantled in order to clean the flues.

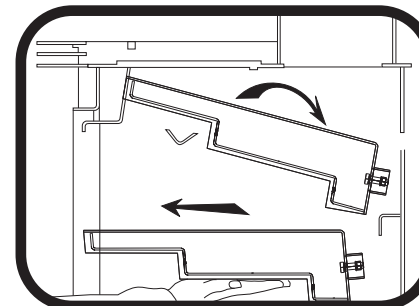

5. Slide the ball inside the upper side of the flue all the way down until it appears inside the stove.

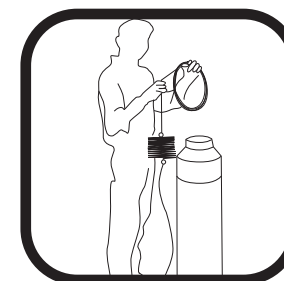

6. Pull the rope inside the stove so that the steel brush moves up the flue. Repeat this operation 6 times. Do not use regular steel wool instead of a steel brush. Keep the door as closed as possible to avoid soot being dispersed outside the stove.

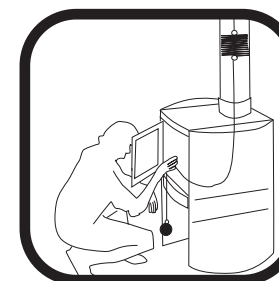

7. To locate the baffle in its regular position follow the indications recommended in the instructions to dismount the baffle.

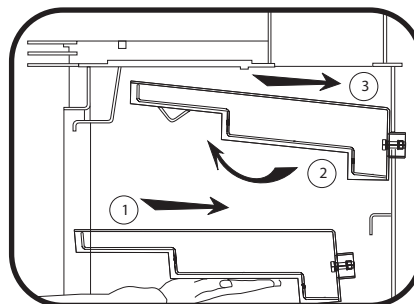

How do I remove the ash from my stove?

The firebox of your stove has a slotted base so that the ashes produced by the combustion of the firewood will be deposited in the ashtray.

Check that your stove is cold and proceed to empty the ashtray in a non combustible container, preferably with a layer of sand on the bottom of it.

Take the ashes outside the house to a safe location. Remember that live coals can remain lit for up to 36 hours. The ash of untreated wood makes an excellent fertilizer for your garden.

## IMPORTANT

Always maintain a bed of ash on the inside of the firebox as this will make the accumulation of live coal and reloading easier.

How do I clean the glass on my stove?

One of the appeals of your Bosca stove is the visible fire. However, often this is limited because of spots that appear on the glass of the stove. To avoid this follow the instructions below:

-The main cause of spots on the glass is directly associated to the use of firewood with high humidity content together with maintaining the Primary Air Control on "minimum". Avoid the occurrence of both by buying dry firewood and storing it correctly and maintaining the Primary Air Control in the "intermediate" position.

-Periodically clean the glass of your stove with Bosca Glass Cleaning Cream.

## CHIMNEY FIRE

What is a chimney fire?

Soot and residue resulting from the combustion of firewood are deposited on the flue. These are called creosote, which is a fuel. Under certain circumstances, the interior of the flue catches fire producing extremely high temperatures that may reach such a level that the flue turns an incandescent red color.

Incandescent creosote emanations may appear on the upper extreme of the flue.

What should I do in the case of a chimney fire?

- Stay calm. A properly installed flue in which the correct materials have been used should resist the situation without problems.
- Close the door of the stove well and close the Primary Air Control. The fire on the inside of the flue will most probably go out in five minutes. Do NOT open the door of the firebox nor of the ashtray until 30 minutes after the chimney fire is extinguished. Otherwise, the fire could reignite.
- Keep an eye on the flue, especially in the area of the roof space.
- Remove any fuel that may be near the flue.
- If the situation prolongs excessively or if you suspect the installation was not properly executed, call the fire department immediately.
- Do not use your stove again until it has been checked by a certified technician.

How can I avoid a chimney fire?

- The key to avoiding a chimney fire is to keep your stove's gas exhaust system clean.
- To keep the flue clean, your stove must function with a vigorous fire. Avoid using your stove with flameless smoking fire.
- Use dry firewood. Humid firewood reduces the temperature of the fire and increases the possibility of a chimney fire.
- When reloading your stove, avoid cooling the existing fire. Place the Primary Air Control on "maximum" and try that the new logs heat fast. Only after this has occurred should you adjust the Primary Air Control to the "intermediate" position.

## OPERATING INSTRUCTIONS

**BOSCA®** FREESTANDING  
WOOD STOVES

### TROUBLESHOOTING

Smoke is coming out of my stove	<ul style="list-style-type: none"> <li>· Check the installation. The cap of the flue must have sufficient space to evacuate smoke and extend 60 cm over the roof of the house.</li> <li>· Reload the stove properly.</li> <li>· Keep the flue of your stove clean.</li> <li>· Check the temperer is correctly installed.</li> </ul>
The glass is dirty	<ul style="list-style-type: none"> <li>· Use firewood with a low percentage of humidity.</li> <li>· Keep the Primary Air Control in the "intermediate" or "maximum" position.</li> <li>· Check that the gasket door sealing (grey ring) is in good conditions.</li> <li>· Remove dirt with Bosca Window Cleaner.</li> </ul>
Stained flues	<ul style="list-style-type: none"> <li>· Use firewood with a low percentage of humidity.</li> <li>· Do not overload your stove to avoid overheating.</li> </ul>
Stove doesn't heat	<ul style="list-style-type: none"> <li>· Use firewood with a low percentage of humidity.</li> <li>· Reload your stove over a good bed of live coals.</li> <li>· Keep the Primary Air Control in the "intermediate" or "maximum" position.</li> </ul>
Visible smoke	<ul style="list-style-type: none"> <li>· Use firewood with a low percentage of humidity.</li> <li>· It is normal to have smoke emissions the first few minutes of ignition, the smoke will ease when the combustion chamber reaches a higher temperature. (this should not take more than 30 minutes)</li> </ul>
Baffle is worn out	<ul style="list-style-type: none"> <li>· If your stove has been in use for more than three years</li> </ul>

### IMPORTANT INFORMATION

Your Bosca stove is identified by a serial number stamped on a plate on the inside of the ashtray door. No other Bosca stove of similar model has the same serial number, which may be requested if you require a service.

(Fill in the information of your stove)

Model:	Serial Number:
Purchase Date:	Distributor:

### SAFETY PRECAUTIONS



The stoves are designed to only use firewood as fuel. The use of any other kind of fuel could damage the stove and make the warranty null and void.



Periodically inspect the flues and clean if necessary. The accumulation of creosote can provoke fires inside the flues.



Keep any flammable materials away from your stove (furniture, curtains, papers, plastic, etc.).



Do not leave clothes or other flammable materials on your stove.



Do not burn large amounts of paper or other flammable materials that may produce a fast and extremely hot fire.



The door of your stove's firebox must remain closed while the fire is on.



The stoves must be properly installed to avoid possible fires. The installation instructions contained in this manual must be strictly adhered to. Prefer an Authorized Installation Service.



Never use gasoline, paraffin or other flammable fuels to light the fire. Do not store gasoline or other flammable fuels near the stove.



Do not make modifications to the installation of the stove without consulting specialized technicians.



If elements close or in contact with stove begin to smoke it is overheating. Do not add more wood, make sure the firebox is well closed and turn off the Air Control completely.



Direct contact with a lit stove can produce serious burns in children and adults.

### Warrantee Conditions:

- Bosca woodstoves come with a full five year warranty on the firebox.
- The warranty does not cover door glass, door seals, fire bricks and baffles.
- The wood fire must have been installed, maintained and operated in accordance with the supplied installation instructions, user guide and the building code, for any claim to be considered.
- Operation of this fire without its baffles, firebricks, door seals, complete glass or doors in place will create an overfired situation resulting in damage will not be covered by warranty.
- Bosca wood fires are painted with high temperature porous paint that will show signs of surface rust if exposed to moisture for an extended period of time.
- Escea (or their agents) liability is limited to the cost of replacing faulty parts or products and hence does not cover any claimed consequential losses, direct or indirect arising from the operation or failure of any part of this wood fire.
- Warranty claims must be directed to a Bosca dealer who must then follow Escea's warranty claim process
- A list of dealers can be found at [www.bosca.co.nz](http://www.bosca.co.nz)